



# LAKE REGION ELECTRIC COOPERATIVE Energy Wise® PROGRAM & RESOURCE GUIDE

Updated 5/1/2026

## PROGRAM & RESOURCE GUIDE TOPICS

- » Energy Wise® Programs
- » Service Procedures
- » Service Revision Procedures
- » Technical Resources

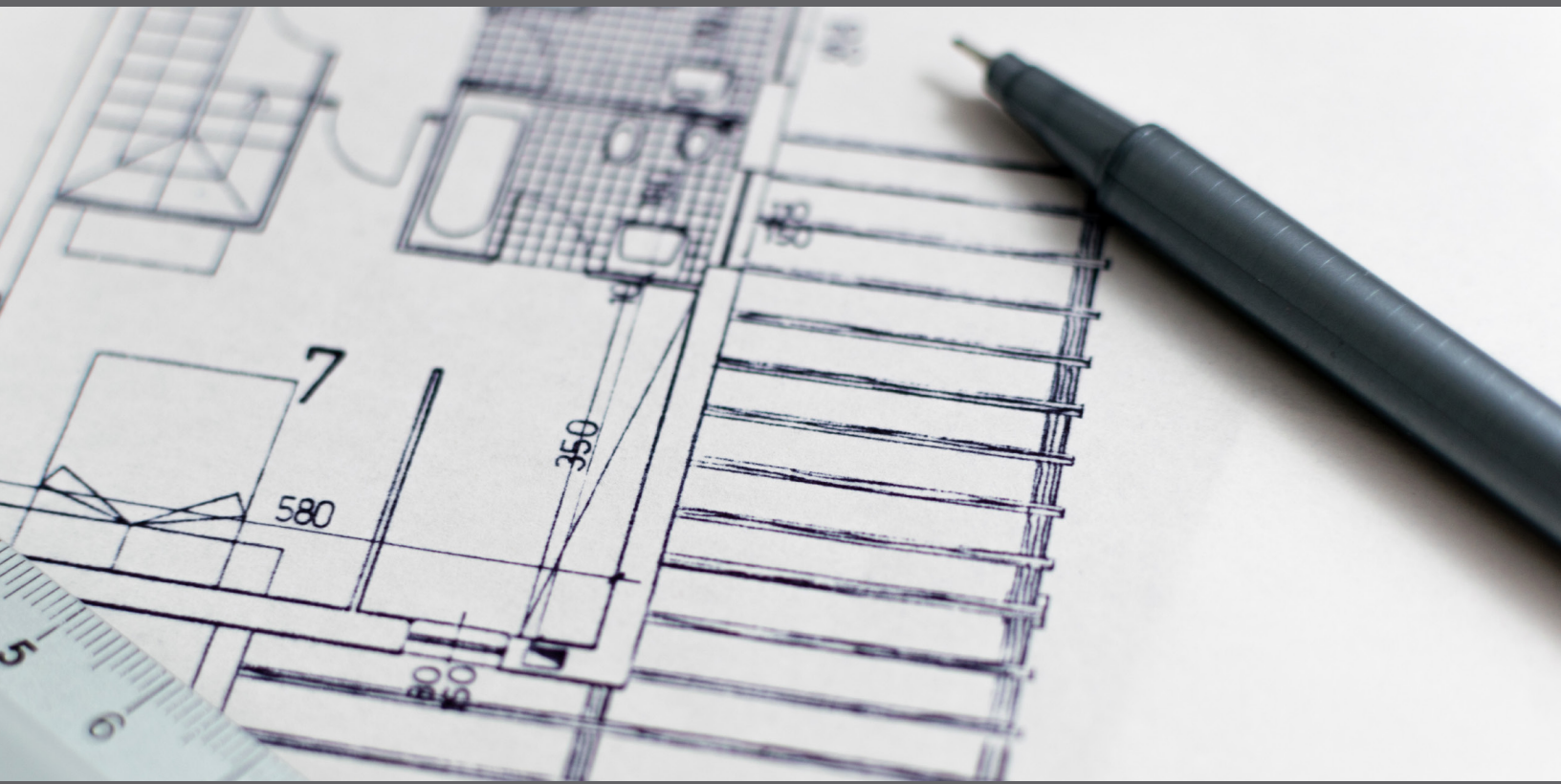

**CONNECT WITH US TO LEARN MORE!**

(800) 552-7658 | [www.lrec.coop](http://www.lrec.coop) |    

# LREC PROGRAM AND RESOURCE GUIDE

## TABLE OF CONTENTS

<b>LREC Contacts</b>	2
----------------------	---

---

### **Program Guides, Rebates and Energy Grants**

---

Residential Program Overview	3
General Requirements and Conditions	3
All Program Rebate Requirements	4
Installation Requirements	4
Energy Wise Program Application Procedure	4
Expected Load Control	5
Energy Grants	5
High-efficiency Installation-based Rebates	5
Rebate Qualification	5
Energy Wise Residential Program Summary	6
Domestic and Non-domestic Fuel Cost Comparisons	7
Energy Wise Program Guides	8-9

### **Procedure**

---

New Services and Service Revisions	10
Underground Services	10
Overhead Services	10
Connections	10
Area Lighting	11
Cable Locating	11
Generator Safety	11
LREC Line Extension Policy Summary	11

### **Resources**

---

Basic Hydronic Underfloor LTS Storage Diagram	12
Basic Hydronic Underfloor Floating Slab Diagram	13
Basic Hydronic Underfloor Standard Installation	14
LM011-LCT-Single LCT Control	15
ETS & Peak Shave Water Heating	16-17
LM010-Two Circuit Connection for Multiple Tanks	18
Water Heaters Available with LREC	19
Steffes Electric Thermal Storage (ETS) Room Units	20
Residential Standby Generator Systems	21-22
ChargeWise Electric Vehicle Charger Programs	23
Electric Vehicle Charger Rebate Application	24
Residential HVAC Rebate Application	25-28
Commercial/Industrial & Ag Retrofit Lighting Rebate	29-31

# LREC CONTACTS

## Pelican Rapids Headquarters or Ottertail Operations Center

---

Local calls	(218) 863-1171
Long distance calls	(800) 552-7658
LREC Website	www.lrec.coop ( <i>Information and forms available</i> )

## Office Hours

---

Monday-Friday: 7:30am to 4:00pm

## Energy Management Specialists (*Load management programs and information*)

---

- » **Steve Haiby**  
Manager of Energy Services  
Direct: (218) 863-9815  
Cell: (218) 205-5602  
Email: [shaiby@lrec.coop](mailto:shaiby@lrec.coop)
- » **Nicki Stetz**  
Energy Management Coordinator  
Direct: (218) 863-9806  
Email: [nstetz@lrec.coop](mailto:nstetz@lrec.coop)
- » **Patrick "PT" Jensen**  
Energy Management Technician Direct:  
Direct: (218) 863-9844  
Cell: (218) 205-1899  
Email: [pjensen@lrec.coop](mailto:pjensen@lrec.coop)
- » **Tanner Brockpahler**  
Energy Management/Service Technician  
Direct: (218) 863-9819  
Cell: (218) 539-0346  
Email: [tbrockpahler@lrec.coop](mailto:tbrockpahler@lrec.coop)
- » **Justin Resch**  
Generator Service Specialist  
Direct: (218) 863-9829  
Cell: (218) 282-0548  
Email: [jresch@lrec.coop](mailto:jresch@lrec.coop)

## Staking Technicians (*New services and service revisions*)

---

- » **Michael Kawlewski**  
*Engineering Manager*  
Direct: (218) 863-9846  
Email: [mkawlewski@lrec.coop](mailto:mkawlewski@lrec.coop)
- » **Dave Boe**  
Direct: (218) 863-9807  
Cell: (218) 849-0794  
Email: [dboe@lrec.coop](mailto:dboe@lrec.coop)
- » **Steve Marty**  
Direct: (218) 863-9825  
Cell: (218) 849-8815  
Email: [smarty@lrec.coop](mailto:smarty@lrec.coop)
- » **Zach Stoll**  
Direct: (218) 863-9877  
Cell: (218) 592-9389  
Email: [zstoll@lrec.coop](mailto:zstoll@lrec.coop)

# Energy Wise<sup>®</sup>

## RESIDENTIAL PROGRAM

### OVERVIEW

Lake Region Electric Cooperative's (LREC) Energy Wise programs give members an option to lower their costs by allowing the utility to manage certain electrical loads. They are available to any member who meets requirements described in this booklet. There are three types of controlled loads:

#### Water Heating

- » 8-hour peak shave minimum 80 gallon storage
- » ETS minimum 100 gallon storage
  - » Mixing valve required
- » See page 6 for details

#### Space Heating

- » Dual fuel
- » Storage space heating
  - » Short-term storage
  - » ETS Long-term storage

## GENERAL REQUIREMENTS & CONDITIONS

Circuits originating from the main load center are metered at the retail rate. Circuits originating from the load management load center are submetered at the off-peak rate.

LCTs require a 240-volt source on the red and black leads. If the LCT is powered by a breaker, the breaker must be rated at 20 amps or less and be wired so that the entire electric heat load is turned off when power to the LCT is interrupted. (See wiring diagram LM011-LCT.)

If the LCT is powered by a circuit with inline fuses, the minimum is a 15 amp slow blow type fuse.

#### Dual Fuel Systems

To qualify for dual fuel programs, the member must have both an electric heating system and an alternate fossil fuel heating system. No exceptions.

The alternate propane, natural gas or fuel oil system must be capable of heating a home and/or garage with average insulation based on 3.5 BTUs per cubic foot or the home's heat loss. It also must be hard wired and be capable of starting and operating automatically during control periods. The alternate heating system must be located on each level or be capable of heating each level of a multi-level home. Wood, corn or pellet systems do not qualify as alternate heating systems. Up to 1500 watts of auxiliary uncontrolled electric heat is allowed in specified areas and must be metered at the retail rate.

\* Minimum load of 5 Kw for Dual Fuel.

#### Heat Pumps

Installation of a heat pump is encouraged. The compressor may be cycled 30 minutes out of every hour for up to six hours daily during the cooling season.

If a ground source heat pump uses domestic well water, the well pump must be wired through the main panel and will be metered at the regular retail rate. EXCEPTION: A separate, dedicated well for the heat pump only is part of the submetered load.

#### Water Heating Programs

Off-peak water heating program requirements vary. Instant on water heaters do not qualify. Please refer to program descriptions for specifics.

# ALL PROGRAM REBATE REQUIREMENTS

Member is required to remain on program for 36 months. Rebates are subject to prorated repayment for early termination. Rebates are subject to change. Please contact LREC to check current rebate status as funds are limited.

## INSTALLATION REQUIREMENTS

### Water Heaters

Unmetered (Peak Shave) and separately single metered water heater controllers may be installed by LREC when installed on a single circuit. If adding a second controlled load to a single existing water heating controlled load, the member is responsible for conversion costs associated with bringing the system into compliance with current LREC requirements.

### Submetered Loads

Most load management programs require a submeter (subtractive metering). A double 200-amp pedestal holding the main service meter and the submeter in one unit is also available. Pedestal cost is billed to the member. *If member is interested in LREC generator program, it may be advantageous to install separate pedestal for direct metering.*

One submeter per rate is allowed. Additional submeters must be approved by LREC and are billed to the customer or contractor per their request. One submeter per structure is recommended since ETS and dual fuel rates as well as domestic and nondomestic rates are different. However, if all loads originate from one submeter, the higher off-peak rate will apply to all loads.

### Construction Sub Meter

When the electric heat portion of a dual fuel off-peak system is used for construction heat, and the backup fossil fuel system is non-operational, LREC may allow a construction phase sub meter installation in a sub panel meter socket between October 1 and May 1 under these conditions:

1. No water service is installed.
2. Some off-peak circuits are operational and controlled by an LREC control box.
3. Owner agrees *in writing* to the following:
  - a. The totally functional back-up system will be completed within six months or by May 1,

whichever comes first.

- b. To notify LREC to perform the final inspection of a dual fuel system.

An adjustment for accumulated kWh on a sub meter will be applied to the bill after inspection and approval when completed by May 1.

### Metered Off-peak Loads

The member is required to provide a submeter socket and distribution panel from which all electric heat and combination water heater circuits will originate. The cost of any modifications required to meet LREC requirements is paid by the member. The use of current transformer metering for submetered loads requires prior approval. Current transformers for submetered loads are supplied by LREC and billed to the owner. All current transformer meter sockets must have a lever bypass.

### Heating Circuits and Wiring

After a completed application has been received, LREC will provide one LCT at no charge to either the member or the electrician on request.

The LCT has two relays:

1. 30 amp single pole, normally-closed relay.
2. 24 volt, 3 amp normally-closed relay.

See diagram inside LCT cover for specific application requirements, LM011-LCT wiring diagram also on page 17 of this book.

All installations must be wired as required by LREC and the National Electric Code (NEC).

### Off Peak System Maintenance

When maintaining or troubleshooting off peak systems, please notify LREC to re-inspect and reseal panels.

## Energy Wise® PROGRAM APPLICATION PROCEDURE

### Homeowner Contacts LREC

- » Energy Wise program material is sent to members on request, or can be found on LREC's website, [www.lrec.coop](http://www.lrec.coop). LREC makes initial on site visit, if necessary.

### LREC Initial On-site Visit

- » Required when adding fossil fuel to existing electric system or when installing short- or long-term storage

and heating systems.

- » Not required for water heater installation or when adding electric heat to existing fossil fuel heating source (minimum 5kW).

### Homeowner Responsibilities

- » Complete load management application and return to LREC and select contractor.

### Contractor Responsibilities

- » Request load control transponder (LCT)
- » Supply and install submeter socket, sub panel and relays according to LREC wiring diagram LM011-LCT and NEC requirements.
- » Notify LREC when installation is completed and provide a wiring certificate number, or mail the utility copy to LREC, P.O. Box 643, Pelican Rapids, MN 56572.
- » Submeter will not be installed without wiring certificate.

### LREC On-site Inspection

- » LREC technician inspects completed installation and installs submeter.

## EXPECTED LOAD CONTROL

Control times are specified for each Energy Wise program. Because of increased demand and higher wholesale costs, control times may approach the maximums.

However, in spite of increased control times, load management programs still make economic sense because the rate is about half of the regular rate for the controlled load.

On a broader scale, load control lowers the demand portion of LREC’s energy bill, which will play an increasingly important role in keeping rates lower.

Daily load control information is available on our website at [www.lrec.coop](http://www.lrec.coop), click *Load Control Button*. *On this page find Sign Up for Notifications to receive updates by text or email.*

## ENERGY GRANTS

### Commercial & Industrial (C&I); Agricultural

C&I and agricultural energy grants are available to qualifying members who make necessary conservation and efficiency improvements.

Grant awards are predetermined for each improvement or installation. Grants for large projects will be calculated on energy savings (and demand savings, if applicable.)

Eligible grant programs include:

- » Retrofit lighting (see page 29-31)
- » C&I cooling
- » Retrofit premium efficiency motors
- » Variable speed drives
- » Custom energy saving projects

Funds are limited and awarded on a first-come, first-served basis.

## HIGH-EFFICIENCY, INSTALLATION-BASED REBATES

### Central A/C and Air Source Heat pumps

This HVAC program is designed to encourage residential installations of high-efficient central air conditioners and air source heat pumps and promote properly installed systems. In order to generate maximum electric energy savings, it is essential that the equipment is installed according to manufacturer’s specifications. This program seeks to validate four components of the installation: proper sizing, air flow, refrigerant charge and duct sealing.

Ductless-mini-split units are not eligible for this rebate, but may be eligible for participation in the EnergyStar appliance equipment program.

## REBATE QUALIFICATION

To qualify for rebates, members must complete a rebate application and submit the appropriate documents. Online or printable forms can be found on our website or by contacting our Energy Services Department. An additional rebate is available if the installing contractor is QI Certified. To determine if your contractor would be eligible you can search for them on the following site: [hvacree.net/gre/public\\_search.cfm](http://hvacree.net/gre/public_search.cfm).

### DUCTLESS AIR SOURCE HEAT PUMP

≤ 1 Ton ≥ 14.3 SEER2 & ≥ 7.5 HSPF2	\$150
≤ 1 Ton ≥ 15.2 SEER2 & ≥ 8.1 HSPF2	\$250
> 1 Ton ≥ 14.3 SEER2 & ≥ 7.5 HSPF2	\$750
> 1 Ton ≥ 15.2 SEER2 & ≥ 8.1 HSPF2	\$1,000

### DUCTED AIR SOURCE HEAT PUMP

≤ 5 Ton ≥ 14.3 SEER2 & ≥ 7.5 HSPF2	\$750
≤ 5 Ton ≥ 15.2 SEER2 & ≥ 8.1 HSPF2	\$1,000

### QI ASHP \*\*

Additional rebate for ductless/ducted ASHP	\$40/ton
--	----------



# LAKE REGION ELECTRIC COOPERATIVE ENERGY WISE RESIDENTIAL PROGRAM GUIDE

## WATER HEATING PROGRAMS

**Peak Shave Interruptible** (requires min. 80 gallon electric water heater)

- » Up to 8-hour control during peak periods
- » \$100 Rebate: grid enabled water heaters
  - » Unmetered: receives a \$10 bill credit when monthly usage over 300 kWh
  - » Metered: 6.68¢ kWh September-May; 7.38¢ kWh June-August

**ETS Storage** (Requires min. 100 gallon electric water heater with mixing valve)

- » Daily load control
- » \$400 Rebate: grid enabled water heaters
  - » Unmetered: receives a \$12 bill credit when monthly usage over 300 kWh
  - » Metered: 6.46¢ per kWh

*Rheem Marathon, lifetime tank warranty, & Rheem heat pump water heaters are available at LREC.*

## ELECTRIC VEHICLE PROGRAM

**EV TOU - Time of Use Rate**

- » Rates from 8.90¢ to 50.00¢ per kWh, see hourly chart
- » Sub meter required

**EV ETS - Storage Rate**

- » 6.46¢ per kWh controlled 16 hours daily
- » Sub meter required

## DUAL FUEL HEATING

A combination of a primary electric and a secondary propane, fuel oil, or natural gas thermostatically controlled heating systems. Either system must be able to provide 100% of home's heating needs on each level. Same requirements for home or garage.

- » 6.68¢ kWh September-May; 7.38¢ kWh June-August
- » Sub meter required
  - » May be controlled any time—up to 12 hours/day, 400 hours per year (normally between 4 p.m. to 10 p.m.)
- » Heat pumps are cycled 50% of each hour during summer peak control times

## SHORT-TERM STORAGE HEATING (STS)

- » 6.68¢ kWh September-May; 7.38¢ kWh June-August
- » Sub meter required
- » Floor Heating requires 6-inch sand cover - proof must be provided to LREC
- » May be controlled any time—up to 12 hours/day, 400 hours per year (normally between 4 p.m. to 10 p.m.)
- » Installed capacity must be at least 125% of the heat loss audit
- » **Steffes storage heaters are available through LREC and qualify for \$25/kW equipment rebate on short-term storage**

## LONG-TERM STORAGE HEATING (LTS)

- » 6.46¢ per kWh used for electric heating.
- » Sub meter required.
- » \$50/kW rebate.
- » Floor Heating requires 12-inch sand cover - proof must be provided to LREC
- » Installed capacity must be at least 175% of the heat loss audit, sized heat load for 16 hours control
- » Daily controlled between 14 to 16 hours
- » **Steffes storage heaters are available through LREC and qualify for \$50/kW equipment rebate on long-term thermal storage**

*All storage heating systems require a professional heat loss audit. A copy of the audit must be submitted for approval with the Load Management Application. LREC inspections are required prior to concrete pour on in-floor systems. For non-residential buildings (detached garages, shops, etc.) Dual Fuel, short term storage and combination 8-hour programs are billed 7.38¢ per kWh for off-peak rate.*

**CONNECT WITH US TO LEARN MORE**

(800) 552-7658 | [www.lrec.coop](http://www.lrec.coop) | [f](#) [@](#) [in](#) [v](#)

# DOMESTIC FUEL COMPARISON (HOME)

Effective 2/23/26							
<b>ELECTRIC HEAT</b>		<b>100% Efficient</b>		<b>200% Efficient</b>		<b>330% Efficient</b>	
<b>COST PER KWH</b>	(Residential)	\$0.0668	\$0.11	\$0.0668	\$0.11	\$0.0668	\$0.11
<b>Efficiency</b>							
<b>NATURAL GAS</b>	90%	\$1.76	\$2.90	\$0.88	\$1.45	\$0.53	\$0.88
LP	90%	\$1.61	\$2.65	\$0.81	\$1.33	\$0.49	\$0.80

# NON-DOMESTIC FUEL COST COMPARISON (GARAGE, SHOP, ETC.)

Effective 2/23/26							
<b>ELECTRIC HEAT</b>		<b>100% Efficient</b>		<b>200% Efficient</b>		<b>330% Efficient</b>	
<b>COST PER KWH</b>	(Residential)	\$0.0738	\$0.11	\$0.0738	\$0.11	\$0.0738	\$0.11
<b>Efficiency</b>							
<b>NATURAL GAS</b>	90%	\$1.95	\$2.90	\$0.97	\$1.45	\$0.59	\$0.88
LP	90%	\$1.78	\$2.65	\$0.89	\$1.33	\$0.54	\$0.80

## FORMULA

(Cost per kWh X efficiency of fossil fuel X BTU of fossil fuel) / (3413 X efficiency of electric)

### KEY

1 kWh	3,413 BTU
1 gal #2 fuel oil	138,700 BTU
1 gal LP gas	91,500 BTU
1 CCF natural gas	100,000 BTU

### ELECTRIC HEAT EFFICIENCIES

Resistance heat	100%
Air-to-air heat pump	200%
Geothermal heat pump	330%

### LOAD MANAGEMENT HEATING RATES

Domestic dual fuel	\$0.0668
Domestic short-term storage	\$0.0668
Domestic Long-term storage	\$0.0646
Non-domestic dual fuel	\$0.0738
Non-domestic short term storage	\$0.0738
Non-domestic long-term storage	\$0.0646

## HOME EXAMPLE

An 80% efficient furnace burns LP gas. The price of LP would have to be \$1.43 per gallon to make it as economical as 100% efficient electric resistance heat at the load management rate of \$0.0668 per kWh. At the regular rate of \$0.011 per kWh, LP would have to cost \$2.36 per gallon. Using the same example, the price of LP gas would have to be \$0.51 per gallon to compare to a 330% efficient geothermal heat pump at the load management rate of \$0.0668 per kWh.

Service charges and tank rental fees are not included in heating costs on the charts. When comparing monthly heating costs, these applicable costs should be included.

## Energy Wise® DUAL FUEL HEATING INCLUDING HEAT PUMPS

### Control Strategy

- » May be controlled anytime up to 400 hours during the heating season up to 12 hours daily, but usually between 4 p.m. and 10 p.m.
- » Heat pumps including ductless mini split units may be cycled during summer peak periods for 30 minutes out of each hour, up to 6 hours daily
- » All dual fuel heating loads need a hard-wired thermostatically controlled fossil fuel back-up, sized and capable of heating all levels

### Incentives

- » Reduced rate on controlled load

*A wood, corn or pellet furnace does not qualify as a secondary heat source.*

**NOTE: Contact Energy Services for non-residential (non-domestic) programs and rates.**

**NOTE: To qualify for central AC and air source heat pump rebates, contractors must be registered through HVACReduction.net. Get more information and registration instructions [www.lrec.coop](http://www.lrec.coop).**

**NOTE: Storage heating systems require a professional (Manual J) heat loss calculation. A copy of the audit must be submitted for approval with the Load Management Application.**

## Energy Wise® STORAGE HEATING

### Short-term storage (STS)

- » Sub meter required
- » May be controlled anytime up to 400 hrs per year. Usually 4 p.m.–10 p.m.
- » Reduced rate on controlled load
- » Btu minimum of 1.25 times the heat loss of the structure
- » 6-inch sand fill (see page 18)
- » LREC inspection required prior to concrete pour

### Long-term storage (LTS)

- » Sub meter required
- » Always controlled 6 a.m.—1 p.m. | 3 p.m.—10 p.m.
- » \$50/kw rebate on ETS load
- » Reduced rate on controlled load
- » Btu minimum of 1.75 times the heat loss of structure
- » 12-inch sand fill (see page 19)
- » LREC inspection required prior to concrete pour

- » Additional rebate on Steffes heating equipment may be available for storage programs. See LREC for details.
- » ETS water heating and an ASHP (controlled as dual fuel) are the only loads allowed with ETS heat on the ETS rate.
- » Fossil fuel backup system is not required with storage heat.
- » Multi-level homes must have sufficient storage capacity on each level.
- » Up to 2,000 watts of uncontrolled electric heat metered at the retail rate are allowed for rooms such as bathrooms and mechanical rooms that could become uncomfortable or where there is danger of freezing during control periods.
- » Building additions with storage heat qualify for the short-term storage program. If this is the only electric heat load, the existing structure does not need to be modified.

<sup>1</sup> In-floor heating systems must be in a sand base, not placed directly in concrete. See diagrams on pages 18-20.

## INTERRUPTIBLE SERVICE

### Small interruptible

- » Controlled load 25-50 kW
- » Contact LREC for basic demand and energy charges

### Long interruptible

- » Controlled load 51 kW or more
- » Contact LREC for basic demand and energy charges

### Requirements

- » Both programs require the entire load to be turned off on demand or automatically transferred to a backup generator.
- » Customer pays electrician to install load control device.
- » Automatic load transfer or disconnect switches are required.
- » Contact energy services specialist for requirements for specific locations.

## **WARNING**

WHEN POWER TO THE LOAD CONTROL DEVICE IS INTERRUPTED, THE CONTROLLED LOAD MAY NOT OPERATE FOR A PERIOD OF UP TO 45 MINUTES AFTER POWER HAS BEEN RESTORED.

## WIRING CERTIFICATE

***PLEASE NOTE: Installations must be approved by LREC before a sub meter will be installed.*** LREC will only schedule a final sub meter installation after all wiring is completed and has received wiring certificate number or physical copy of certificate. Installation of the Load Controller (LCT) should be within a reasonable time period established by LREC.

# NEW SERVICES & SERVICE REVISIONS

## Communication

Communication between owners, contractors and LREC is essential since guidelines vary between utilities. LREC contact numbers are on page 2.

## New Services

New customers must complete and return a membership application to LREC. An LREC staking technician will contact the applicant and set up an appointment to meet on site, if necessary. To obtain a membership application, call customer service or download one from LREC's website.

## Service Revisions

The member or contractor should contact customer service for service revisions. A service order will be issued and a staking technician will contact either the member or the contractor.

## Work Order

When all requirements are met, a work order is issued for construction. These requirements may include easements, payments, permits, deposits, and wiring certificates. Work order schedules are based on the time of year, workload, and the length of time necessary to complete all requirements. During peak construction periods (spring/fall), construction wait times may approach 4 to 6 weeks. Early planning and communication may shorten construction wait times.

## Wiring Certificate

A copy of the wiring certificate must be on file at LREC headquarters before a meter will be installed. If wiring is done by the homeowner, the state electrical inspector must inspect the wiring before the meter is installed.

## Meter Location

LREC meters are normally placed at a pole or meter pedestal. In platted areas, the pole or pedestal will be placed on lot lines. Final meter location will be determined by LREC (see the LREC Line Extension Policy Summary on page 10).

## Meter connection

LREC connects all services and installs all meters.

# UNDERGROUND SERVICES

## Meter Pedestal

LREC provides a 200 amp main meter pedestal at no additional cost for new services. Service revisions may have an associated charge.

## Meter Pedestal Size

LREC uses a 200 amp single or double position meter pedestal for standard installations. Double pedestals are used on lot lines to serve more than one consumer. Other meter pedestals may be purchased from LREC:

- » Single 320 amp
- » Combination 200 amp main x 200 amp off peak
- » Combination 320 amp main x 320 amp off peak
- » Combination 320 amp main x 200 amp off peak

# OVERHEAD SERVICES

## Pole services

LREC will provide the pole and, in most cases, the owner will provide the meter loop on the pole.

## Disconnects and Bypass Requirements

Required disconnects must be provided by the owner or contractor. LREC will direct meter up to a 400-amp service with a class 320 amp meter. A lever bypass is required on 320 amp sockets. LREC no longer sells 200 amp straight or D.T. switches.

## Current Transformer Metering

LREC will determine when current transformer metering will be used for the main service. Current transformer metering will not be done solely for convenience. All current transformer meter sockets must have a lever bypass.

# CONNECTIONS

## Routine Connections

Scheduling a non-emergency, routine connection requires a 48-hour notice. Call customer service to schedule a connection (see page 2).

## Wiring to Metering Point

The owner or contractor is responsible for all wiring beyond meter point including installation of a temporary service. Owner's wires must be brought to a point no more than two (2) feet from a meter pedestal or meter pole, or the service will not be connected. For underground services, a minimum of two (2) feet of wire above the meter socket from the required wire burial depth should be left for connection purposes. Consumer will be billed for splices and wire, if the wire is not long enough.

## Wiring Connection

LREC will not connect exposed wires. Wires temporarily placed on top of ground must be placed in schedule 80 conduit and the conduit route marked with stakes and caution tape strung between the stakes.

## Removing Meters

LREC will remove direct-wired or current transformer meters for revision work or building maintenance at no charge during normal business hours. Contractors may remove non-current transformer meters, if the contractor enters into a hold harmless agreement with LREC. Contractors must notify LREC before a meter and seal is removed and notify LREC when the meter has been reinstalled.

## AREA LIGHTING

LED lights can be purchased or leased from LREC. Contact LREC for current price.

### Purchased

Purchased lights can be installed on existing secondary low voltage cooperative poles or on new wooden poles only. LREC will sell and install new poles. Lights cannot be installed on high voltage poles.

The consumer is required to provide service wires from the metered side of the service to the light. LREC will charge for maintenance or repairs.

### Leased Lighting

LREC has LED area lights available through a leased lighting program.

Under the terms of the Lighting Agreement, LREC installs, owns and maintains the lighting fixtures on existing poles adjacent to roadways and driveways. Energy is billed at a fixed monthly rate. Customer will be charged for additional poles and wire needed for mounting the lights.

## CABLE LOCATING

### Gopher State One Call

LREC abides by the rules of Minnesota's Gopher State One Call law. An owner or contractor must notify Gopher State One Call at (800) 252-1166 at least 48 hours before excavation begins.

## GENERATOR SAFETY

If you have a standby generator that's connected directly to the electrical system, a transfer switch is required to prevent back feeding.

## LREC LINE EXTENSION POLICY SUMMARY

An LREC staking technician works with members to determine the best route for power based on location and load requirements. (Policy requirements are subject to change.)

### New Single Phase Extensions

- » \$500 (plus applicable taxes) new service extension fee
- » Footage and transformer charges to be determined

### New Three Phase Extensions

- » \$500 (plus applicable taxes) new service extension fee
- » Footage and transformer charges to be determined.

### Developments

Subdivision line extensions will be measured from existing facilities to the farthest point where electric service will be built. If greater than 300 feet, single phase construction charges apply. The line extension charge will be reduced by a lot credit, which is determined by the size of each lot. The cooperative designates service locations, which are generally along roads and lot lines. Additional charges may apply if service is brought to a different location.

### Short-term Service

When short term service is required, the customer pays the estimated cost of construction and retirement minus the salvage value of reusable materials. Payment is required prior to construction.

### Additional Charges

Charges for special equipment such as pad mount transformers, special metering equipment, road bores and permits may be included in payments, but are in addition to line extension charges.

### Financing and Payment Schedule

Line extension charges greater than \$2,000 may be financed at LREC's current blended interest rate plus one percent for up to three years. Payments are not refundable.

# BASIC HYDRONIC UNDERFLOOR

LTS Storage – 14 to 20 hour

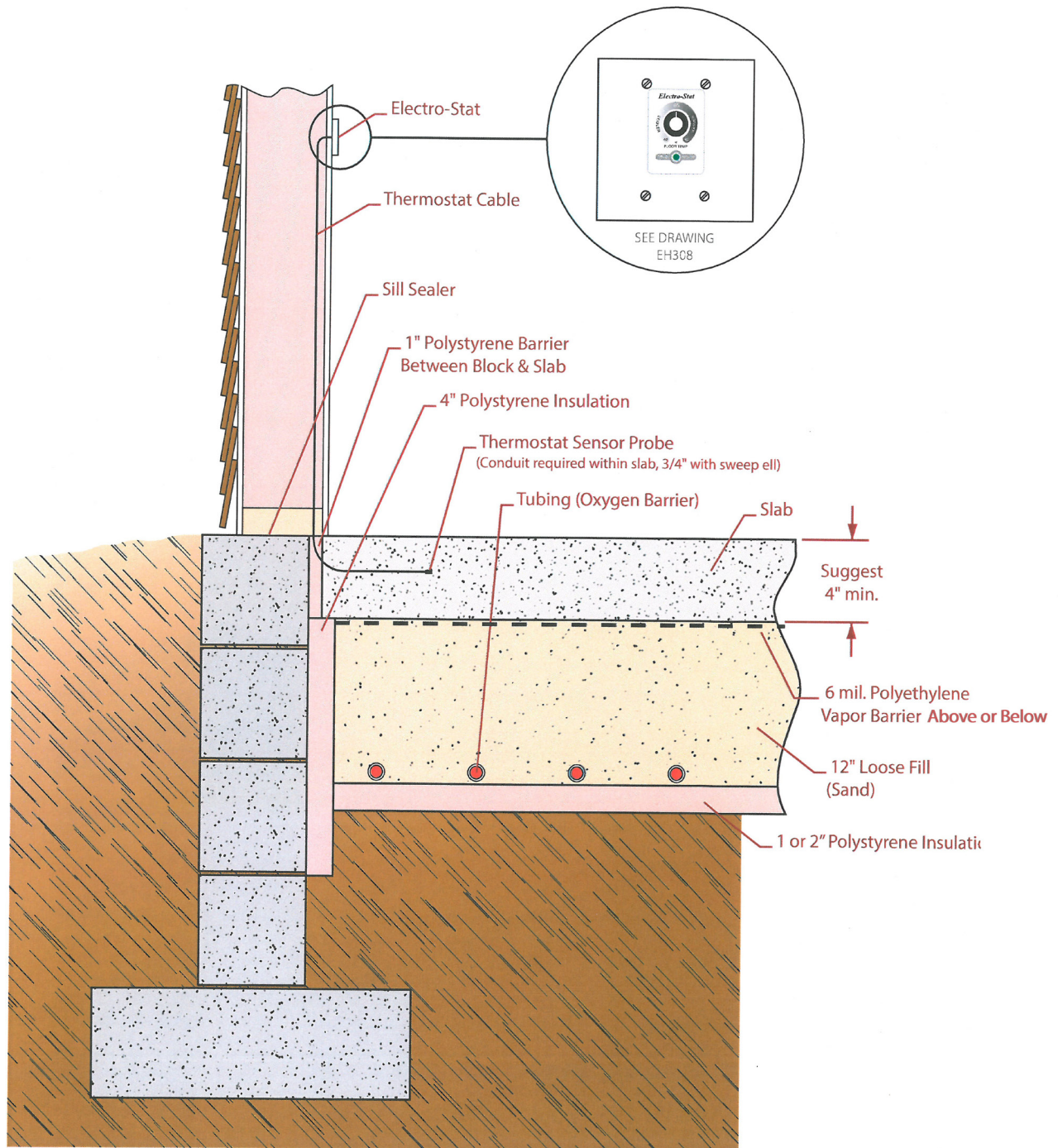

Typical installation — sand base required for storage, check with contractor if recommending horizontal insulation below sand.

# BASIC HYDRONIC UNDERFLOOR

## Floating Slab - STS

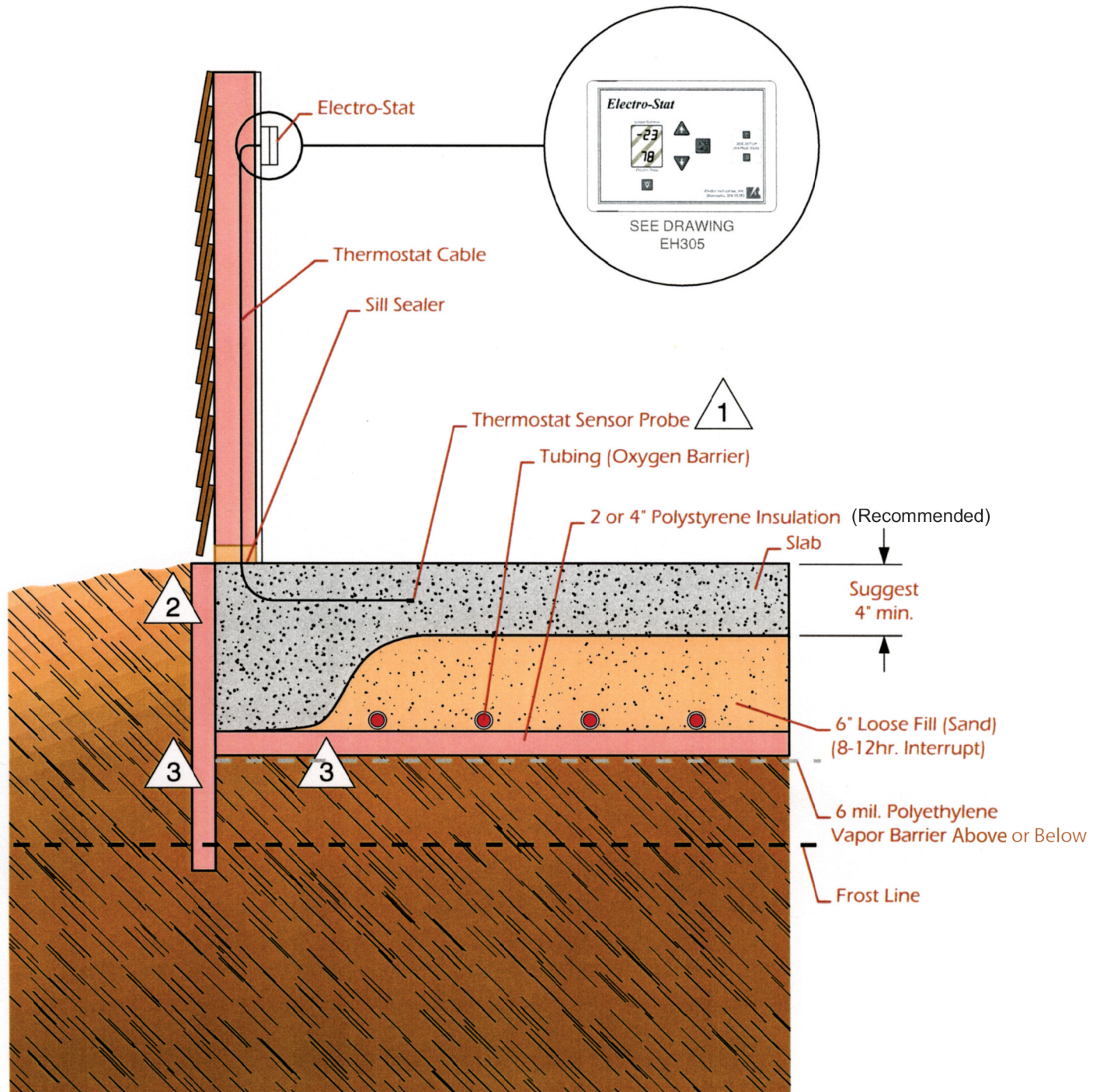

**Notes:**

1. Conduit required within slab, 3/4" with sweep ell.
2. If "floating slab", need screen to prevent rodent entry.
3. bottom or flat insulation board can also be extended 2'-3' outside of the slab. rodent screen becomes more difficult with this concept.

Typical installation — sand base required for storage, check with contractor if recommending horizontal insulation below sand.

# BASIC HYDRONIC UNDERFLOOR

Standard Installation, back up needed for Dual Fuel Program

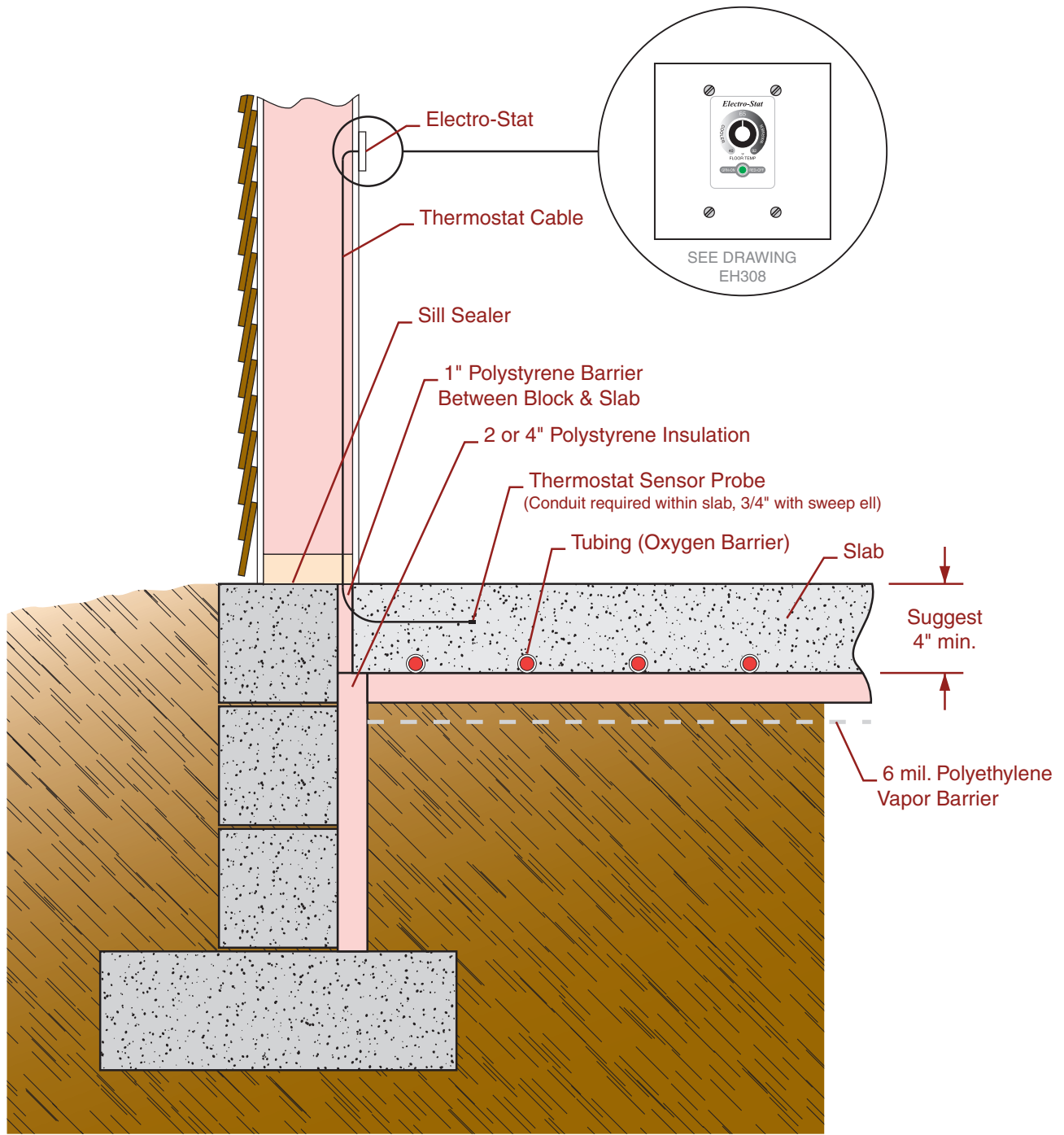

Typical installation — sand base required for storage, check with contractor if recommending horizontal insulation below sand.

# SINGLE LCT CONTROL

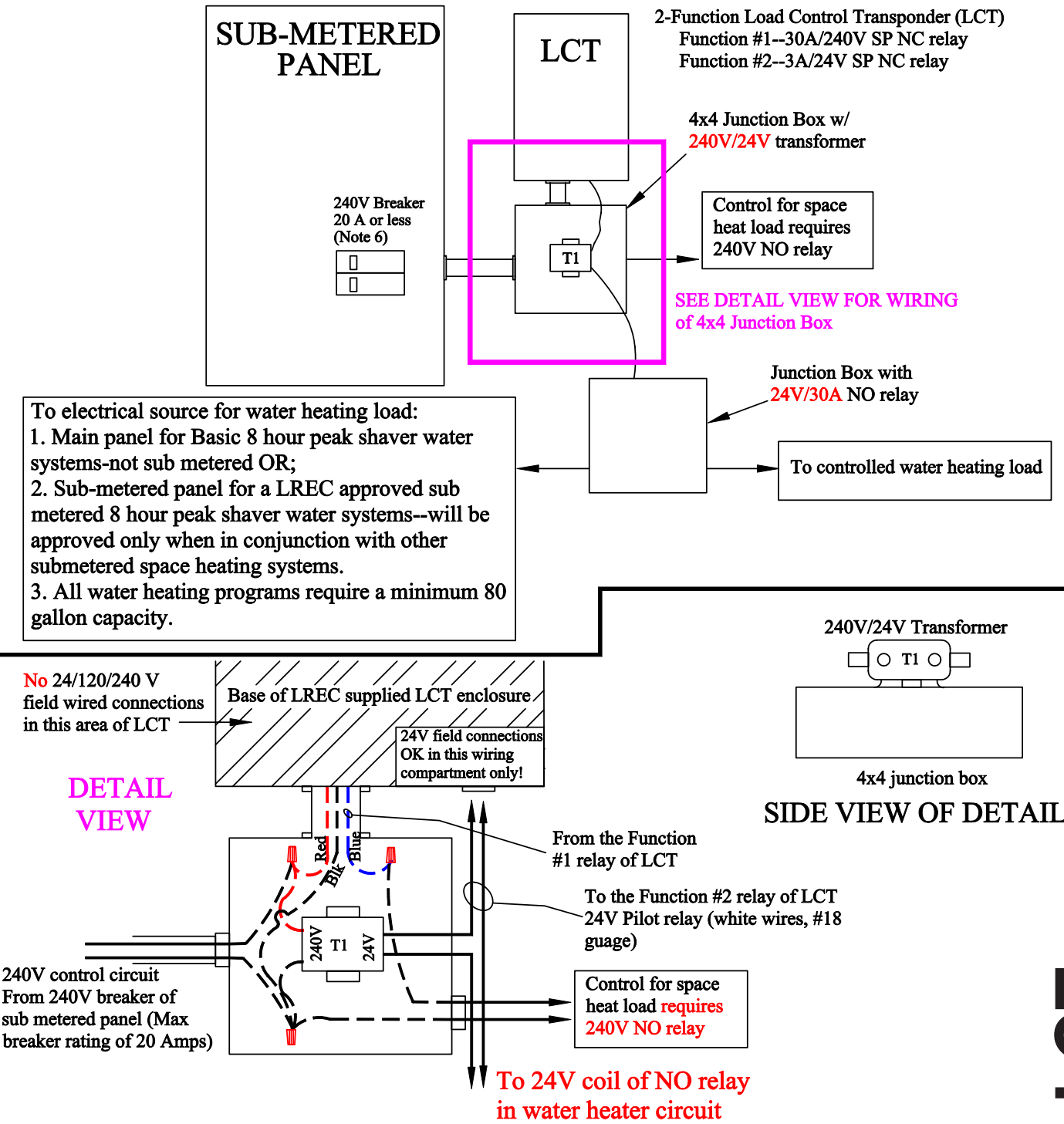

To electrical source for water heating load:  
 1. Main panel for Basic 8 hour peak shaver water systems-not sub metered OR;  
 2. Sub-metered panel for a LREC approved sub metered 8 hour peak shaver water systems--will be approved only when in conjunction with other submetered space heating systems.  
 3. All water heating programs require a minimum 80 gallon capacity.

No 24/120/240 V field wired connections in this area of LCT

DETAIL VIEW

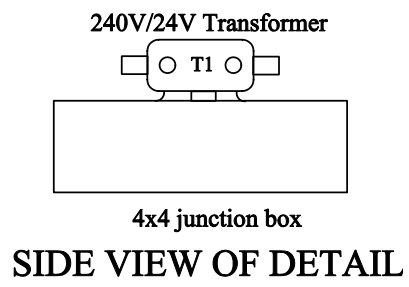

## NOTES:

1. **IMPORTANT:** circuits **MUST** be wired so that by turning off power to the LCT all controlled loads will be in a controlled (off) state.
2. LCT can be tapped onto 240V circuit controlling off peak space heat loads as long as breaker rating is 20 amps or less. If this cannot be done the LCT must be fed from a dedicated 240V circuit of 20 amps or less.
3. All LREC load control equipment must be located adjacent to the service panel.
4. LREC supplies the LCT. The customer is responsible for all wiring & associated costs to complete installation to conform with LREC specifications.
5. Normally open/normally closed refers to the relay in it's de-energized state. An energized LCT in its uncontrolled state will energize any space heat or water heater relays.
6. NEC 725.51

NC=Normally Closed; NO=Normally Open; SP=Single Pole

LM011-LCT



# LAKE REGION ELECTRIC COOPERATIVE WATER HEATER PROGRAM GUIDE

## ELECTRIC THERMAL STORAGE (ETS) WATER HEATING

An ETS water heating system uses inexpensive off-peak electricity to “charge” a water heater with sufficient hot water to supply your needs while the electric supply is interrupted during the on-peak hours the following day.

### ETS Control – Separately metered

- » Minimum 100-gallon electric water heater
- » \$400 rebate
- » Mixing valve required (contractor provided)
- » 6.46¢ per kWh year-round

### ETS Control – Unmetered

- » Minimum 100-gallon electric water heater
- » \$400 rebate
- » \$12 monthly bill credit
- » Mixing valve required (contractor provided)
- » Home must use 300 kWh per month to qualify

### ETS Control – Combination metered

- » Minimum 100-gallon electric water heater
- » \$400 rebate
- » Metered with ETS space heating system
- » Mixing valve required (contractor provided)
- » 6.46¢ per kWh year-round

### ETS Charge & Control Hours

- » Charge hours (on)—weekdays 8 hours: 10pm-6am
- » Control hours (off)—weekdays 16 hours: 6am-10pm
- » Weekends and holidays are only controlled as needed

## PEAK SHAVE INTERRUPTIBLE WATER HEATING

The interruptible strategy allows LREC to temporarily interrupt electricity during times of peak electric usage—usually on the hottest or coldest days of the month—while still providing hot water for all your needs.

### 8 Hour Peak Shave – Separately metered

- » Minimum 80-gallon storage or 50-gallon heat pump electric water heater
- » Rebate available based on type
- » 6.68¢ per kWh (Sept.–May)
- » 7.38¢ per kWh (June–Aug.)
- » Up to 8 hour control during peak times »

### 8 Hour Peak Shave – Combination metered

- » Minimum 80-gallon storage or 50-gallon heat pump electric water heater
- » Rebate available based on type
- » Metered with dual fuel or short term storage heating system
- » 6.68¢ per kWh (Sept.–May)
- » 7.38¢ per kWh (June–Aug.)
- » Up to 8 hour control during peak times

### 8 Hour Peak Shave – Unmetered

- » Minimum 80-gallon storage or 50-gallon heat pump electric water heater
- » Rebate available if connected for peak shave
- » 10 monthly bill credit
- » Home must use 300 kWh/month to qualify
- » Up to 8 hour control during peak times



**CONNECT WITH US TO LEARN MORE!**

(800) 552-7658 | [www.lrec.coop](http://www.lrec.coop) | [f](#) [@](#) [in](#) [v](#)

# ELECTRIC THERMAL STORAGE WATER HEATING: 100 GALLON TANK MINIMUM



## Energy Conservation Tips and Recommendations

- » Set lower thermostat to 150 degrees; top thermostat to 140 degrees.
- » Install mixing valve and set so hot water temperature at faucet is 115 degrees.
- » Install low-flow shower heads and faucet aerators.
- » Insulate a minimum of the first 10 feet of pipe from water heater.
- » Wash clothes in cold water except for very dirty loads.
- » Always use cold water rinse for laundry.
- » Do not use circulation pumps on hot water line.
- » Try to limit using large volumes of hot water during control times.

## ETS Charge & Control Hour

- » Controlled: 14-16 hours a day
- » Charge time: 8-10 hours a day

## More information

Contact customer service at (880) 552-7658 or visit [www.lrec.coop](http://www.lrec.coop).

# TWO CIRCUIT CONNECTION FOR MULTIPLE TANKS

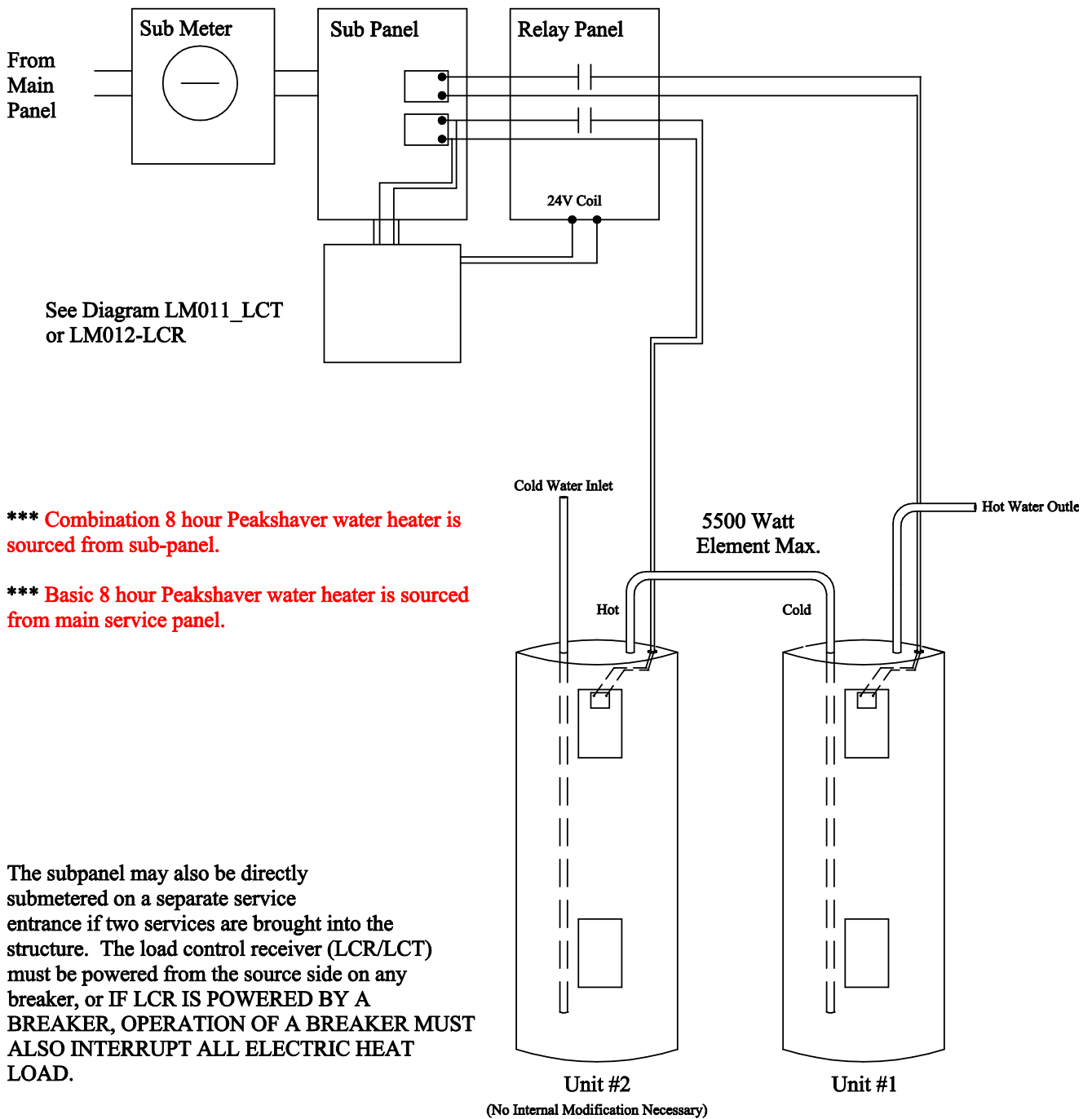

ALL EQUIPMENT TO BE PROVIDED BY CONSUMER EXCEPT FOR LCR/LCT AND METER.

LM010



# LAKE REGION ELECTRIC COOPERATIVE WATER HEATER PACKAGES + REBATES

Updated 6/2026

## WATER HEATER OPTIONS

Lake Region Electric Cooperative (LREC) offers two different water heater options: *Marathon* and *Rheem Heat Pump*. The water heaters range in size from 50-100 gallons, and are kept in-stock at our headquarters in Pelican Rapids, MN. Both water heater options have the ability to be added to our demand response program (load control/off-peak), and qualify for **EASY-PAY**, which is 0% interest, on-bill financing through LREC. Learn more through our informational sheet below or call (800) 552-7658.

\*Rebates and incentives are available for grid enabled water heaters installed on one of LREC's load control programs.

\*Taxes are included in the pricing provided.

### MARATHON GRID ENABLED WATER HEATER

MARATHON WATER HEATERS	DIRECT PURCHASE	EASY-PAY (36 MONTHS)	REBATES (OFF-PEAK)	RATES	PRODUCT SPECS		
					WEIGHT (LBS)	HEIGHT (IN)	WIDTH (IN)
85 GALLON (MRG85245)	\$2,102.86	\$58.41	\$100	PEAKSHAVE	134	66.25	28.25
100 GALLON (MRG105245)	\$2,141.07	\$59.47	» \$100 » \$400 (ETS)	» PEAKSHAVE » ETS	152	66.75	30.25

- » Poly Material Tank
- » Energy Rating up to 0.92 EF
- » Lifetime Residential Tank Warranty
- » No Anode Rod Needed



### RHEEM HEAT PUMP WATER HEATER

RHEEM WATER HEATERS	DIRECT PURCHASE	EASY-PAY (36 MONTHS)	REBATES (OFF-PEAK)	RATES	PRODUCT SPECS		
					WEIGHT (LBS)	HEIGHT (IN)	WIDTH (IN)
50 GALLON (PROPH50T2RH400-30)	\$2,438.26	\$67.73	\$400	PEAKSHAVE	178	62	22.25
80 GALLON (PROPH80T2RH375-30)	\$3,186.64	\$88.52	\$400	PEAKSHAVE	244	75	24.25

- » Energy Star Rated
- » Energy Rating up to 4.07 EF
- » Multiple Operation Modes for Energy Savings
- » Limited Stock on hand may need to special order



### AQUANTA WATER HEATER PILOT PROGRAM

LREC is seeking participants to join our Aquanta water heater pilot program. Through this program, LREC members will receive a no-cost Aquanta retrofittable water heater controller. This cellular-enabled controller works through an app that must be downloaded by the member and is a fast, easy way to start conserving energy and saving money. With this controller, you can see usage data, remotely turn your water on/off, receive maintenance and leak alerts, view hot water available, and so much more!



**CONNECT WITH US TO LEARN MORE!**

(800) 552-7658 | [www.lrec.coop](http://www.lrec.coop) | [f](#) [i](#) [in](#) [v](#)



# LAKE REGION ELECTRIC COOPERATIVE SPACE HEATING PACKAGES + REBATES

## ELECTRIC THERMAL STORAGE (ETS) SPACE HEATING

Take advantage of low-cost off-peak rates with a Steffes room unit. During off-peak hours, the Steffes ETS space heater converts this low-cost electricity into heat and stores that heat in specifically designed bricks located inside the unit. The heater's built-in room thermostat initiates the fan to deliver this stored heat within the area as needed, maintaining constant comfort.

### Steffes room unit overview

- » Safe, clean, comfortable heat
- » Replaces wood stoves, wall furnaces or electric baseboards and is easy to operate
- » No routine maintenance
- » Comfortable radiant heat with quiet variable speed fan
- » Manufactured in the United States
- » Perfect for a variety of buildings and residences

### Unique features

- » Microprocessor technology and variable speed blower
- » Low cost automatic charge control
- » Heater operation display lights
- » Built-in digital room temperature thermostat
- » Brick core and air discharge temperature safety controls
- » Built-in controls to reduce installation time and costs

### Product details

- » ETS heater stores off-peak energy (*no back-up system required*)
- » Qualifies for 6.46¢ ETS rate and 6.68¢ dual fuel rate
- » Expanded charge hours now available for 5.5¢ ETS rate
- » Up to \$50 per kW rebate available
- » **EASY-PAY** available with 48 month financing
- » 100% efficient and great for a single room or entire home
- » 5-year limited manufacturer's warranty

### Components

- » Heat storage bricks
- » Insulation
- » Heating element
- » Temperature control and display panel
- » Warm discharge air and blower
- » Brick core temperature sensor

## STEFFES ROOM UNITS SPECIFICATIONS

Standard voltage on all systems is 240VAC. Charging input voltage of 208 and 277 are also available.

MODEL	KW INPUT	WEIGHT LBS (APPROXIMATELY)	DIMENSIONS (INCHES)			MINIMUM CLEARANCE REQUIREMENTS (INCHES)	
			LENGTH	HEIGHT	DEPTH		
2102	3.0	267	30	24.5	10.5	TOP	4
2103	4.5	376	37	24.5	10.5	FRONT	15
2104	6.0	478	55	24.5	10.5	SIDES	2
2105	7.5	585	51	24.5	10.5	BACK	1.5
2106	9.0	692	58	24.5	10.5		

LREC will size and price a steffes system for your needs

## ETS SPACE HEATING CHARGE + CONTROL HOURS

- » Charge hours (on)—daily 10 hours: 10pm–6am and 2pm–4pm
- » Control hours (off)—daily 14 hours: 6am–2pm and 4pm–10pm



CONNECT WITH US TO LEARN MORE

(800) 552-7658 | [www.lrec.coop](http://www.lrec.coop) | [f](#) [@](#) [in](#) [v](#)



# LAKE REGION ELECTRIC COOPERATIVE STANDBY GENERATOR SYSTEMS

Updated 6/2026

## BENEFITS OF OWNING A GENERATOR SYSTEM

Our standby power systems are designed to provide peace of mind and keep your life uninterrupted. The lights stay on, the sump pump keeps running, and your furnace or AC keeps your family comfortable. Our standby generator system intelligently powers your whole house, automatically powering what you need when you need it most.

Benefits of an LREC generator:

- » Generator automatically starts when the power goes out
- » Sold, delivered and start-up completed by LREC
- » Eligible for a 48-month **EASY-PAY** plan
- » From Briggs & Stratton—The Power Experts!
- » Runs on natural gas or LP (contact provider for connection)
- » Omnimetrix monitoring system **Introduced in 2023**



## GENERATOR OPTIONS



### 13KW POWER PROTECT

Pricing starts at \$10,007



### 18KW POWER PROTECT

Pricing starts at \$10,932



### 26KW POWER PROTECT

Pricing starts at \$12,623

*Our energy management team will help you choose the appropriate generator size and transfer switch for your home.*

## GENERATOR PACKAGES

Each generator installation includes the following:

- » Generator Power Protect Series with a 7 year warranty
- » LREC Briggs & Stratton Certified Technician
- » Cold weather kit and battery
- » Concrete pad
- » Exterior indicator light
- » One-year remote monitoring (Value of \$216.00)
  - Subscription renewal needed to continue service
- » First annual maintenance (Value of \$336.90)
  - LREC will notify for future purchases & pricing

## AUTOMATIC TRANSFER SWITCHES

LREC offers two types of automatic transfer switches:

### Power Management and Standard ATS.

These switches automatically transfer your home's power source to the standby generator during an outage. This ensures a seamless transition from utility power to generator power, providing reliable backup without added worry for the homeowner.

**Contact LREC Energy Management to schedule a site visit.**

**CONNECT WITH US TO LEARN MORE!**

(800) 552-7658 | [www.lrec.coop](http://www.lrec.coop) |    



# LAKE REGION ELECTRIC COOPERATIVE STANDBY GENERATOR OMNIMETRIX MONITORING SYSTEM

## OMNIMETRIX MONITORING SYSTEM

Thank you for purchasing a Lake Region Electric Cooperative (LREC) standby generator system! With your generator, you now have access to the Omnimetrix monitoring system. Omnimetrix monitors generator systems 24/7/365, and alerts owners and LREC technicians immediately of all alarm conditions. With Omnimetrix, you have peace of mind to ensure your standby generator will be ready to go when you need it most.

## OMNIMETRIX BENEFITS

Omnimatrix monitoring allows generator owners to accurately pinpoint systems that could potentially fail-to-start, reducing 95% of these events. With Omnimatrix, you will have increased reliability and security. Other benefits include:

- » Staying informed on battery health, immediate outage notifications, generator output, and if the generator is in “Auto” mode.
- » Receive email and/or text messages with important information about your generator; our technician can sign you up.
- » Access to OmniView, the cloud-based dashboard which shows the status of the generator.
- » Cellular-based monitoring means you’re not dependent on Wi-Fi systems which could fail during an outage.

## SIGNING UP FOR OMNIMETRIX TEXT ALERTS

- » With your consent, your LREC technician will sign you up for text alerts. You will receive the exact message as shown in the graphic from the number 76197.
- » LREC suggests you add this contact to your phone and label it “LREC Generator Alerts.”
- » No other action is needed.

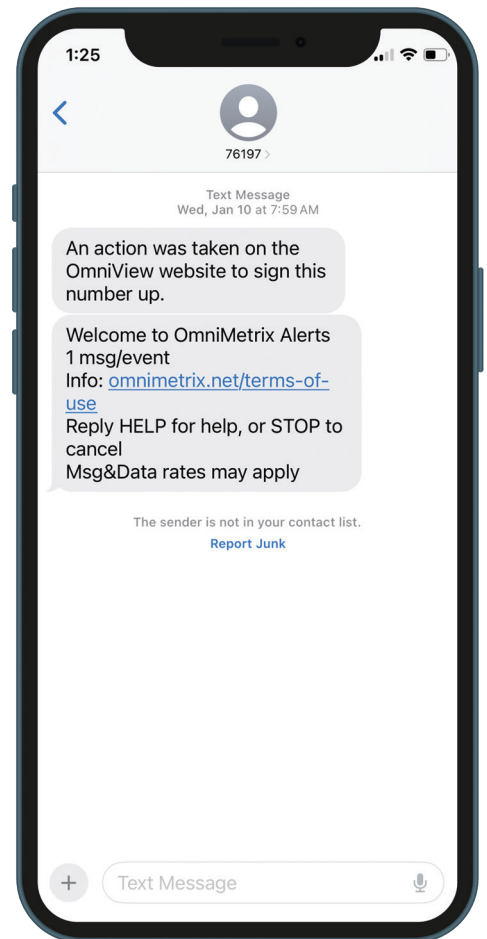

## SIGNING UP FOR OMNIMETRIX EMAIL ALERTS

- » With your consent, your LREC technician will sign you up for email alerts. You will receive an email from *omx@omnimatrix.net*.
- » LREC suggests you add this contact to ensure it doesn’t go into a spam folder.
- » No other action is needed.

**CONNECT WITH US TO LEARN MORE!**

(800) 552-7658 | [www.lrec.coop](http://www.lrec.coop) |    

LREC is an equal opportunity provider and employer.

- » EPA-est. 265 miles of range
- » Electric all-wheel drive
- » Magneride suspension
- » 480 horsepower
- » 600 lb.-ft./814 Nm torque
- » 0-60 mph in 3.8 seconds

*extended-range battery stats*



- » EPA-est. 320 miles of range
- » Electric all-wheel drive
- » 580 horsepower
- » 775 lb.-ft./814 Nm torque
- » 0-60 mph in 4.0 seconds
- » 10,000lb towing capacity

*extended-range battery stats*



## PLUG IN WITH LREC

LREC offers three rate options: *time-of-use*, *storage*, and *plug-in hybrid electric vehicle (PHEV)*. The time-of-use rate allows members to choose what time they charge their EV and how much they want to pay. The storage rate has predetermined charging times set by LREC and is the lowest cost option. The PHEV charging rate remains the same at all times but is controlled with LREC's dual fuel program, which is approximately 3.5 days/month for 4.5 hours of control. Utilizing these rate options requires a separate sub-metered circuit be installed to accommodate an Electric Vehicle Supply Equipment (EVSE) charging station.

### ELECTRIC STORAGE RATE

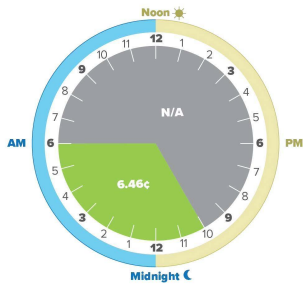

ELECTRIC STORAGE RATE	
TIME	RATE
10:00pm–6:00am	6.46¢
6:00am–10:00pm	N/A

HYBRID RATE	
TIME	RATE
Anytime	7.38¢

### TIME-OF-USE RATE

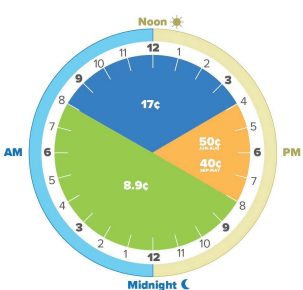

TIME-OF-USE RATE							
JUNE–AUGUST	MON	TUES	WED	THUR	FRI	SAT/SUN	HOLIDAYS
8:00pm–8:00am	8.90¢	8.90¢	8.90¢	8.90¢	8.90¢	8.90¢	8.90¢
8:00am–4:00pm	17.00¢	17.00¢	17.00¢	17.00¢	17.00¢	8.90¢	8.90¢
4:00pm–8:00pm	50.00¢	50.00¢	50.00¢	50.00¢	50.00¢	8.90¢	8.90¢
SEPTEMBER–MAY							
8:00pm–8:00am	8.90¢	8.90¢	8.90¢	8.90¢	8.90¢	8.90¢	8.90¢
8:00am–4:00pm	17.00¢	17.00¢	17.00¢	17.00¢	17.00¢	8.90¢	8.90¢
4:00pm–8:00pm	40.00¢	40.00¢	40.00¢	40.00¢	40.00¢	8.90¢	8.90¢

### HYBRID RATE

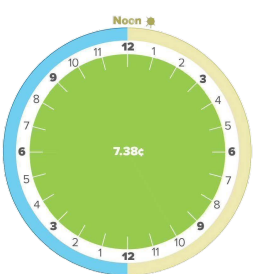

### EVSE REBATES

LREC's ChargeWise program offers a rebate of up to \$500 towards the installation of a Level 2 EVSE charging station when installed on one of LREC's EV rates. Information regarding the rebate can be found at [www.lrec.coop/ev](http://www.lrec.coop/ev).



Lake Region Electric Cooperative  
 PO Box 643  
 1401 South Broadway  
 Pelican Rapids, MN 56572

# Electric Vehicle (EV) Charger Installation Residential Rebate Application



## Member Information

Name \_\_\_\_\_ Account # \_\_\_\_\_  
 Address where EV is installed \_\_\_\_\_  
 City \_\_\_\_\_ State \_\_\_\_\_ ZIP \_\_\_\_\_ Phone \_\_\_\_\_  
 EV Make/Model/Year \_\_\_\_\_

## Electric Vehicle Service Equipment (EVSE) Information

Manufacturer \_\_\_\_\_ kW \_\_\_\_\_  
 Charger Type: Level 2 \_\_\_\_\_ Charger is on rate: EVTOU \_\_\_\_\_ ETS (storage) \_\_\_\_\_

## Contractor Information

Name \_\_\_\_\_ City \_\_\_\_\_ State \_\_\_\_\_

Rebate is available for an EV charger (Level 2) purchased on or after January 1, 2026. The charger must be installed where electricity is supplied by Lake Region Electric Cooperative (LREC). Rebate submittal must follow the guidelines as outlined by the cooperative. LREC is not responsible for inaccurate information supplied by vendors.

I certify that the EV charger for which I am claiming a rebate is a qualifying appliance, that it has been installed on an LREC EV Rate at the address listed above and that address represents a valid account with the cooperative.

Signature \_\_\_\_\_ Today's date \_\_\_\_\_

### Important:

- Call LREC at 218.863.1171 or toll free at 800.552.7658 to verify program status, prior to purchase.
- Rebate amount is up to \$500 for qualifying EV charger installed on an LREC EV Rate.
- EV charger must be installed within LREC's service territory.
- Fill out this form completely. Incomplete forms will not be processed.
- Include your account number and sign the form.
- Submit completed rebate form and a copy of the original sales receipt within 60 days of purchase date to:  
**EV Rebate, LREC, PO Box 643, Pelican Rapids, MN 56572 or rebates@lrec.coop**
- For questions, call LREC at 218.863.1171 or toll free at 800.552.7658.
- Rebate program is subject to change or cancellation without notice.



# LAKE REGION ELECTRIC COOPERATIVE RESIDENTIAL ENERGY EFFICIENCY REBATES

Updated 4/26

LREC's rebate opportunities give you all the choices you need to make your home and business more energy efficient. In addition to LREC's rebates, the Inflation Reduction Act (IRA) has the potential to provide LREC members with additional tax credits and rebates. To learn more about IRA and the savings offered, please visit [www.energy.gov/save](http://www.energy.gov/save).

- Rebates must be purchased/installed between Jan 1, 2026, and Dec 15, 2026
- Request for rebates must be submitted to LREC by December 15, 2026. Once funds have been depleted, rebates will cease for the year.
- Total rebate amount **will not** exceed the total of purchase & installation costs.

## HEATING + COOLING

<b>HEAT PUMP SYSTEMS</b>  <i>Ductless/Ducted ASHP (limit 1 per account/year)</i>  <i>Geothermal Heat Pump (limit 1 per account/year)</i> <i>Max Rebates of</i> <ul style="list-style-type: none"> <li>• \$4,000 – New</li> <li>• \$2,000 - Replacement</li> </ul>	<b>DUCTLESS AIR SOURCE HEAT PUMP</b> $\leq 1$ Ton $\geq 14.3$ SEER2 & $\geq 7.5$ HSPF2 $\leq 1$ Ton $\geq 15.2$ SEER2 & $\geq 8.1$ HSPF2 $> 1$ Ton $\geq 14.3$ SEER2 & $\geq 7.5$ HSPF2 $> 1$ Ton $\geq 15.2$ SEER2 & $\geq 8.1$ HSPF2	\$150 \$250 \$750 \$1,000
	<b>DUCTED AIR SOURCE HEAT PUMP</b> $\leq 5$ Ton $\geq 14.3$ SEER2 & $\geq 7.5$ HSPF2 $\leq 5$ Ton $\geq 15.2$ SEER2 & $\geq 8.1$ HSPF2	\$750 \$1,000
	<b>GEOHERMAL HEAT PUMP, CLOSED LOOP</b>	NEW system, including loop field \$400/ton REPLACEMENT heat pump \$200/ton
<b>QI ASHP ***</b>	QI additional rebate for ductless/ducted ASHP	\$40/ton
<b>ELECTRIC THERMAL STORAGE (ETS) HEATING SYSTEMS</b>	Steffes ETS Systems on Short Term Storage	\$25/KW
	All ETS Systems on Long Term Storage	\$50/KW  <i>(max rebate of \$2,000)</i>

\*\*\*Additional rebate if the installing contractor is QI certified. To determine if a contractor is eligible a search can be completed online at [www.lrec.coop/qicontractors](http://www.lrec.coop/qicontractors)

## WATER HEATING \* Water Heater must be on a load management program

<b>HEAT PUMP WATER HEATER</b>	Must be ENERGY STAR	\$400
<b>ETS WATER HEATER (5.5¢ RATE)</b>	Must be at least 100 gallons, grid enabled, with mixing valve	\$400
<b>PEAK SHAVE WATER HEATER</b>	Must be at least 80 gallons, grid enabled	\$100

## ELECTRIC VEHICLE (EV) Charger must be on an EV rate

<b>CHARGER INSTALLATION</b>	Level 2 Charger – must be hard wired (limit 1 per account)	Up to \$500
-----------------------------	--	-------------

**CONNECT WITH US TO LEARN MORE!**

(800) 552-7658 | [www.lrec.coop](http://www.lrec.coop) | [f](#) [@](#) [in](#) [v](#)

*All rebates are subject to change.*

*Please contact LREC to verify availability.*

# HEATING AND COOLING REBATE APPLICATION

## 2026 Rebate Form

Must be purchased/installed between Jan 1, 2026 and Dec 15, 2026  
Submissions for 2026 Rebates must be completed using current forms

Request for rebates must be submitted to LREC by **December 15, 2026**.  
Once funds have been depleted, rebates will cease.



## Member Information

Name \_\_\_\_\_ Account # \_\_\_\_\_

Address \_\_\_\_\_

City \_\_\_\_\_ State \_\_\_\_\_ Zip \_\_\_\_\_ Phone \_\_\_\_\_

By signing this application, I certify the appliances for which I am claiming a rebate are qualifying products and are installed at the address listed above which represents a valid cooperative account.

Signature \_\_\_\_\_ Today's Date \_\_\_\_\_

## Equipment and Installation Information - Air Source Heat Pump

### Ductless Air Source Heat Pump Systems ≤ 1 ton

\_\_\_ High Efficiency (≥ 14.3 SEER2 & ≥ 7.5 HSPF2) \$ 150.00

\_\_\_ Premium Efficiency (≥ 15.2 SEER2 & ≥ 8.1 HSPF2) \$ 250.00

### Ductless Air Source Heat Pump Systems > 1 ton - 5 tons

\_\_\_ High Efficiency (≥ 14.3 SEER2 & ≥ 7.5 HSPF2) \$ 750.00

\_\_\_ Premium Efficiency Tier (≥ 15.2 SEER2 & ≥ 8.1 HSPF2) \$ 1,000.00

### Ducted/Hybrid Air Source Heat Pump Systems up to 5 tons

\_\_\_ High Efficiency (≥ 14.3 SEER2 & ≥ 7.5 HSPF2) \$ 750.00

\_\_\_ Premium Efficiency Tier (≥ 15.2 SEER2 & ≥ 8.1 HSPF2) \$1,000.00

Manufacturer \_\_\_\_\_

Condenser model number \_\_\_\_\_ Condenser serial number \_\_\_\_\_

Evaporator coil model number \_\_\_\_\_ Evaporator coil serial number \_\_\_\_\_

Furnace model number (if new) \_\_\_\_\_ Furnace serial number \_\_\_\_\_

Is Air Source Heat Pump Connected to Off-Peak/Load Management Yes \_\_\_\_\_ No \_\_\_\_\_

## Equipment and Installation Information - Ground Source Heat Pump

### Ground Source Heat Pump (GSHP) qualifying criteria – Closed loop only; must be ENERGY STAR listed

Manufacturer \_\_\_\_\_ Model Number \_\_\_\_\_

Total Tons \_\_\_\_\_ Type of Installation: New System \_\_\_\_\_ Replacement Compressor(s) \_\_\_\_\_

Type of Ground Source Heat Pump: Open \_\_\_\_\_ Closed \_\_\_\_\_

Is Ground Source Heat Pump Connected to Off-Peak/Load Management Yes \_\_\_\_\_ No \_\_\_\_\_

## Contractor Information

*NOTE: An invoice showing purchase date, equipment, manufacturer, model numbers and serial numbers along with AHRI certificate must be submitted with application. On new systems, an invoice for loopfield installation is required also.*

Contractor Company Name \_\_\_\_\_

Phone \_\_\_\_\_ City \_\_\_\_\_ State \_\_\_\_\_

Is your HVAC Contractor listed as a Qualified Installer? Yes \_\_\_\_\_ No \_\_\_\_\_ (see page 3 for QI Installer information)

## IMPORTANT:

- Check with cooperative for qualifying rebate amounts.
- Product(s) must be installed within the cooperative's service territory.
- To verify specific model efficiency ratings or ENERGY STAR certification status please visit the following resources
- Ductless ASHPs – <https://www.ahridirectory.org/Search/SearchHome?ReturnUrl=%2fhttps://www.energystar.gov/productfinder/product/certified-furnaces/results>  
<https://www.ahridirectory.org/Search/SearchHome?ReturnUrl=%2fhttps://www.energystar.gov/productfinder/product/certified-geothermal-heat-pumps/results>

**\*Rebate program is subject to change or cancellation without notice. Call cooperative if there are questions on program status.\***

## Items needed for your submission:

- Rebate Form
- Invoice/Paid Receipt (a copy is ok)
- AHRI Certificate (aka Certificate of Product Rating)

Return by mail to LREC

P.O. Box 643

Pelican Rapids, MN 56572

Or scan and send by email to [rebates@lrec.coop](mailto:rebates@lrec.coop)

# Heating and Cooling

## 2026 Reference and Conversion Sheet

**Notice:** On January 1, 2023 the Department of Energy (DoE) began using a new testing procedure to rate the efficiency of air conditioners and air source heat pumps. These changes require new metrics (SEER2/EER2/HSPF2) that were derived from the DoE's new test procedure (M1) rather than the historical metrics (SEER/EER/HSPF) from the old test procedure (M).

The simple conversion table below will help you to identify air conditioning (AC) and air source heat pump (ASHP) equipment that qualifies for ENERGYWISE rebates in 2025 using the following steps.

**Step 1:** Determine what ratings system was used for the equipment model that you plan to purchase.

**Step 2:** Confirm that the efficiency ratings of the new equipment exceeds the requirements for the rebate measure you are applying for using the table below to convert between the old and new efficiency ratings when needed.

SEER	DUCTED SEER2	DUCTLESS SEER2
14.0	13.4	14.0
14.5	13.8	14.5
15.0	14.3	15.0
15.5	14.8	15.5
16.0	15.2	16.0
17.0	16.2	17.0
17.5	16.7	17.5
18.0	17.2	18.0
19.0	18.1	19.0
20.0	19.0	20.0

EER	DUCTED EER2	DUCTLESS EER2
10.2	9.8	10.2
11.0	10.5	11.0
11.5	11.0	11.5
11.7	11.2	11.7
12.0	11.5	12.0
12.2	11.5	12.2
12.5	12.0	12.5
13.0	12.5	13.0

HSPF	DUCTED SPLIT HSPF2	DUCTED PACKAGE HSPF2	DUCTLESS HSPF2
8.0	6.8	6.7	7.7
8.2	7.0	6.9	7.9
8.8	7.5	7.4	8.4
9.0	7.7	7.6	8.6
9.5	8.1	8.0	9.1
10.0	8.5	8.4	9.5
11.0	9.4	9.2	10.4

NOTE: The cross references for efficiency in the above tables should be noted as approximate.

### Items of Note to Member:

- Rebates \$500 and under will be issued as a credit to the electric bill. Any rebate greater than \$500 will be issued as a check and mailed to address on file for the member. LREC reserves the right to issue rebates as a credit on the electric bill if the member's account is in a "past due status". Allow 6-8 weeks for processing.
- Limit of one ductless, ducted or ground source heat pump per member per year. Rebates are a first-come, first-serve basis while funds are available.
- Product(s) must be installed within the cooperative's service territory.

# Residential Quality Installation (QI) Program

---

## QI Certified Contractors:

A QI certified contractor has passed a QI assessment and/or is North American Technician Excellence (NATE) installation certified and have agreed to following industry best practices regarding the proper installation of equipment. This program validates four components of the installation: proper sizing, airflow, refrigerant charge and duct leakage.

Equipment purchased from and installed by non-QI certified contractors is not eligible for the rebate.

A list of QI certified contractors can be found at [https://hvacree.net/gre/public\\_search.cfm](https://hvacree.net/gre/public_search.cfm). Information on how to be a certified contractor or ordering forms can be found at <https://greatriverenergy.com/smart-energy-use/installations/>.

## Rebate Details:

Rebate amounts vary depending on the efficiency rating, the type of equipment and whether there is a special promotion going. Contact your electric cooperative for specific rebate details and availability. This rebate program is subject to change without notice.

## Qualifying Members:

Members applying for the rebate must be a member of and receive residential electric service from one of Great River Energy's participating cooperatives.

Members are responsible for meeting all of the program requirements, and for complying with any government or third-party requirements, including applicable codes, ordinances, rules or regulations regarding the installation of the equipment.

## Qualifying Equipment:

Equipment must be a new, high efficient central air conditioner or air source heat pump with an efficiency of 15 SEER/14.3 SEER2 or higher. The system must be matched meaning the outdoor condenser unit and the indoor evaporator coil were designed by the manufacturer to work together. No commercial, reconditioned, or ground source heat pumps qualify for the QI rebate program.

Only equipment listed on the Air-Conditioning, Heating & Refrigeration Institute (AHRI) website ([www.ahridirectory.org-residential](http://www.ahridirectory.org-residential)) will qualify. The AHRI list is dynamic and changes frequently, therefore AHRI certificates that are printed within two weeks of the installation date will be honored and must be submitted with the rebate form.

The use of the furnace's variable speed fan to increase the SEER/SEER2 rating above the nominal rating will be allowed for determining rebate eligibility provided the furnace was installed within one year prior to the central air equipment purchase.

## Application Details:

Rebate form must be completed, signed by contractor and submitted to the electric cooperative along with the following:

- Equipment invoice, all information on the invoice must precisely match the information on the rebate application or the application will not be processed
- AHRI certificate for installed equipment

An application that is denied due to equipment ineligibility will not be accepted with changed model numbers.

If conditions do not allow for proper testing (see equipment testing section below), the member will be eligible for the rebates as long as testing is completed and application submitted by July 31 of the following year.

It is the member's responsibility to ensure that the electric cooperative receive the rebate application materials. The electric cooperative is not responsible for any lost, late, stolen, ineligible, illegible, misdirected, or "postage due" mail. All completed submissions become the property of the electric cooperative and will not be returned. Warning: Fraudulent submission of the form may result in prosecution for mail fraud pursuant to Title 18 US Code sections 1341 and 1342.

## Testing the Equipment:

The contractor must activate the system and perform the appropriate tests for airflow and refrigerant charge. These tests can only be conducted when the outdoor (ambient) temperature meets the manufacturer's specifications. Rebate applications may not be submitted until testing is complete.

## Liability:

By participating in this program, the member agrees that the electric cooperative has no liability concerning the quality, safety and/or installation of the equipment, estimated energy savings, workmanship of any third parties, or use of any equipment. The electric cooperative shall not be liable for the work performed by the members engineer, contractor or vendor. Participation by a contractor in this program does not constitute an endorsement by the electric cooperative of the contractor, or a guarantee of the quality of the work.

The electric cooperative is not responsible if the heating and cooling contractor, retailer, builder or any other party provides the member with inaccurate information about the amount or qualifications of the actual rebate. The electric cooperative will not rebate equipment that has been mislabeled or misrepresented.

# Lighting



## LED Lighting Retrofit Rebate Application

### BUSINESS MEMBER INFORMATION

Business Name \_\_\_\_\_  
Installation Address \_\_\_\_\_  
City \_\_\_\_\_ State \_\_\_\_\_ ZIP \_\_\_\_\_  
Contact Name \_\_\_\_\_ Account # \_\_\_\_\_  
Email \_\_\_\_\_ Phone \_\_\_\_\_

### REBATE RECIPIENT

To release the rebate incentive check to an alternate party other than the cooperative business member, the member must specify an alternative mailing address and authorize with a signature below.

Please Send Rebate to (check one):

Business Member       Alternative Recipient

Recipient Name \_\_\_\_\_  
Mailing Address \_\_\_\_\_  
City \_\_\_\_\_ State \_\_\_\_\_ ZIP \_\_\_\_\_  
Contact Name \_\_\_\_\_

### APPLICATION CHECK LIST

Rebate application with signature     Itemized project invoices (labor & materials)     Equipment specifications

The undersigned does hereby certify that the undersigned is solely responsible for the accuracy of the information contained in this application. All rules of the program have been followed and the installation is complete. The undersigned acknowledges that nothing contained in the application imposes any liability on the cooperative for the work performed and information presented by the member, member's engineer, contractor, or vendor. The undersigned also authorized payment of incentive directly to the specified rebate recipient.

**Rebate applications due no later than the third Friday in November.**

### MEMBER SIGNATURE

Member Signature \_\_\_\_\_ Date \_\_\_\_\_

### WARRANTY INFORMATION

Rebate qualifications do not imply any representation or warranty of such equipment, design or installation by the cooperative. The cooperative shall not be responsible or liable for any personal injury or property damage caused by this equipment. The cooperative does not guarantee that a specific level of energy or cost savings will result from the implementation of energy conservation measures or the use of products funded under this program. In no event shall the cooperative be liable for any incidental or consequential damages.

### LIGHTING

- All prescriptive lighting fixture rebates will be for equipment that is DLC or ENERGY STAR listed. Equipment that does not meet this requirement can be rebated through the Custom Lighting program.
- Energy Star and DLC requirements must match the application of LED installations.
- Rebates are based on installed equipment of one-for-one replacement of incandescent fixtures, fluorescent T12 lamps and fixtures, or other fixture type that produce similar kW savings.
- If the project is not a one-for-one retrofit: A project with a reduction in fixtures can be applied for under Custom Lighting. If a project is a lighting redesign, a photometric layout is required and can be applied for under Custom Lighting.
- LED linear replacement lamps are based on a one-for-one replacement of fluorescent lamps. LED lamp must be DLC listed can be the follow types of lamps: UL Type A "plug and play", UL Type B internal-driver/line voltage, or UL Type C external driver
- Automatic controls must be permanently installed.
- LED exit signs rebates can be for incandescent or fluorescent to LED.
- Either the fixture or the lamps for a project will be rebated; not both.
- Rebate amount shall not exceed 50% of the total project cost.
- Total rebate per member shall not exceed **\$5,000** annually.

# Lighting



## Equipment & Rebate Information

### LED RETROFIT LIGHTING

#### LAMPS – Screw & Pin – 50% minimum wattage reduction required

Wattage	< 20w – 60w	61-100w	101-140w	141 – 160w
Annual hours of operation				
Rebate	\$2	\$5	\$10	\$15
Quantity				
Total				

#### LED Tubes

Lamp Size	4' LED Lamp - < 18w Replaces T12 or T8 lamps	5' – 6' Case Lamp Refrigerator/Freezer
Rebate	\$5	\$20
Quantity		
Total		

#### LED Fixtures – Troffers, Downlights, Recessed Cans, Pendants & Surface Mounted – 50% minimum wattage reduction required

Wattage	< 25w	26w-50w	51-75w
Rebate	\$10	\$15	\$20
Quantity			
Total			

#### LED Fixtures – Wallpacks, Soffits, Canopy, Hi-Bay/Lo-Bay, Pole Mounted & Roadway Lighting – Replaces HID or T12 50% minimum wattage reduction required

Wattage	< 40w	41-80w	81-120w	121-200w	201-250w	251-300w	301-400w
Rebate	\$25	\$35	\$50	\$65	\$80	\$100	\$120
Quantity							
Total							

#### Automated Controls: New construction and retrofit applications

CONTROL STRATEGY	REBATE AMOUNT PER kW CONTROLLED
Occupancy sensor	\$15.00
Daylighting	\$20.00
Personal tuning	\$15.00
Task tuning	\$15.00
Multiple strategies (any combination of 2 or more of the above listed control strategies)	\$30.00
Networked lighting controls (NLC) w/o luminaire level lighting controls (LLLC)*	\$30.00
Networked lighting controls (NLC) w/ luminaire level lighting controls (LLLC)*	\$50.00

\*NLC rebate eligibility requires an intelligent network of individually addressable luminaires and control devices, allowing for the interactive application of multiple control strategies. NLC with LLLC controls rebate eligibility requires that the sensors are integrated into each individual fixture that is part of the NLC system being rebated.

AREA/SPACE NAME	CONTROL STRATEGY INSTALLED	TOTAL CONNECTED kW	REBATE (kW x REBATE AMOUNT) FROM TABLE ABOVE
(Example)	Daylighting	1	\$20.00

#### Prescriptive Rebate

Project Cost	
Total Rebate	

**MUST COMPLETE NEXT PAGE**

## Equipment & Rebate Information

### CUSTOM AND RETROFIT LIGHTING

- This page must be completed for both LED Lighting Retrofit and Custom Lighting before the application can be processed.
- LED Lighting retrofit rebates will be determined based on the prescribed dollar amount per quantity on the previous page.
- LED Lighting retrofit rebates will be based on the quantity and wattage of the new LEDs being installed, not the quantity of the old lighting. The quantity in the new lighting section should match the quantity on the LED Lighting Retrofit page.
- Custom lighting will be evaluated project by project and the rebate amount should be confirmed with your local cooperative.

### Old Lighting

Description of Space	Custom or Retrofit	Quantity	Wattage	Heating	Hrs/Year	A/C
				<input type="checkbox"/> Yes <input type="checkbox"/> No		<input type="checkbox"/> Yes <input type="checkbox"/> No
				<input type="checkbox"/> Yes <input type="checkbox"/> No		<input type="checkbox"/> Yes <input type="checkbox"/> No
				<input type="checkbox"/> Yes <input type="checkbox"/> No		<input type="checkbox"/> Yes <input type="checkbox"/> No
				<input type="checkbox"/> Yes <input type="checkbox"/> No		<input type="checkbox"/> Yes <input type="checkbox"/> No
				<input type="checkbox"/> Yes <input type="checkbox"/> No		<input type="checkbox"/> Yes <input type="checkbox"/> No
				<input type="checkbox"/> Yes <input type="checkbox"/> No		<input type="checkbox"/> Yes <input type="checkbox"/> No
				<input type="checkbox"/> Yes <input type="checkbox"/> No		<input type="checkbox"/> Yes <input type="checkbox"/> No
				<input type="checkbox"/> Yes <input type="checkbox"/> No		<input type="checkbox"/> Yes <input type="checkbox"/> No
				<input type="checkbox"/> Yes <input type="checkbox"/> No		<input type="checkbox"/> Yes <input type="checkbox"/> No
				<input type="checkbox"/> Yes <input type="checkbox"/> No		<input type="checkbox"/> Yes <input type="checkbox"/> No

### New Lighting

Description of Space	Custom or Retrofit	Quantity	Wattage	Heating	Hrs/Year	A/C
				<input type="checkbox"/> Yes <input type="checkbox"/> No		<input type="checkbox"/> Yes <input type="checkbox"/> No
				<input type="checkbox"/> Yes <input type="checkbox"/> No		<input type="checkbox"/> Yes <input type="checkbox"/> No
				<input type="checkbox"/> Yes <input type="checkbox"/> No		<input type="checkbox"/> Yes <input type="checkbox"/> No
				<input type="checkbox"/> Yes <input type="checkbox"/> No		<input type="checkbox"/> Yes <input type="checkbox"/> No
				<input type="checkbox"/> Yes <input type="checkbox"/> No		<input type="checkbox"/> Yes <input type="checkbox"/> No
				<input type="checkbox"/> Yes <input type="checkbox"/> No		<input type="checkbox"/> Yes <input type="checkbox"/> No
				<input type="checkbox"/> Yes <input type="checkbox"/> No		<input type="checkbox"/> Yes <input type="checkbox"/> No
				<input type="checkbox"/> Yes <input type="checkbox"/> No		<input type="checkbox"/> Yes <input type="checkbox"/> No
				<input type="checkbox"/> Yes <input type="checkbox"/> No		<input type="checkbox"/> Yes <input type="checkbox"/> No
				<input type="checkbox"/> Yes <input type="checkbox"/> No		<input type="checkbox"/> Yes <input type="checkbox"/> No

### Custom Projects

<b>Project Cost</b>	
<b>Total Rebate</b>	